

makePretty

Pilot Project

Safe Operation Practices · Service · Troubleshooting

Table of Contents

Included List	04
Preamble	05
Instructions	06
Precautionary Information	08
Reference Information & Safe Operation Practice	09

General Information

Getting Started	09 - 11
-----------------	---------

About the Product

Care & Use	11- 17
------------	--------

Maintenance

Interior Care

Wheel Care

Plant Info Sheet	17- 22
------------------	--------

Japanese Aucuba

Mahonia Aquifolium

Mountain Laurel

Calluma Vulgaris

Jasminum Nudiflorum

makePretty Kit Includes:

One (1) MakePretty Cart

Four (4) philips head screws for mounting additional hardware

One(1) Stainless Steel push attachment

Three(3) U Bolts

Two(2) Bike Trailer attachments

Two (2) Tapulin tarps

Two(2) Replacement Bike Wheels

Sixteen(16) Japanese Aucuba

Fifteen(15) Mountain Laurel

Twenty(20) Mahonia Aquifolium

Fifteen(15) Jasminum Nudiflorum

Ten(10) Calluna Vulgaris : ‘Firefly”

Welcome to the MakePretty user guide, in this guide you will find a variety of fun facts that, if followed carefully will help you with your cart.

Important Safe Operation Practices

- 1)** Ensure you collect your makePretty and makePretty kit from a local distribution center, they should help you get your plant and your money disbursement set up within a reasonable time frame.
- 2)** Once you receive your base kit, attach the wheels stored inside the makePretty kit to the wheel bolts on the outside located near the bottom. It's sometimes easier to have volunteers onsite to assist you otherwise, it's as simple as screwing them in at the designated symbol markings at the top of the wheel nut.
- 3)** Attach the push or bike attachment to the front of the cart using the push button activation, make sure you hear the click as the cart locks itself into the attachment.
- 4)** Ask a friend or a volunteer to help you put the preliminary plants onto your structure, these can be done anyway you would like, but make sure the plants described are placed in the sun appropriate zones. You wouldn't want to be caught with dead plants!
- 5)** Push or Bike away with your new makePretty Kit. The sky is limitless with what you can do, and you can go anywhere with it! Just make sure you take care of it and it should last you for years!

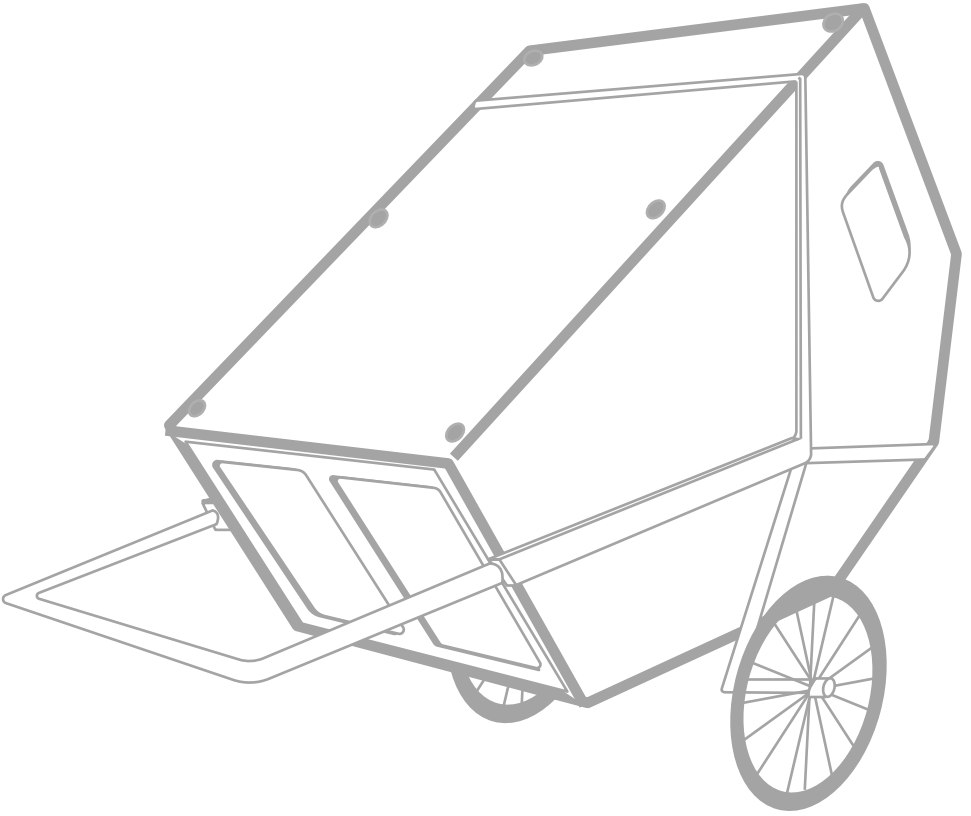

Precautionary Information

Your MakePretty Cart is a cart designed to be your shelter, and has the ability to transform ordinary city spaces with the power of plants. Should the need arise a group of administrative operators can check on your cart in some situations of misuse. If absolutely needed users of makePretty participants can volunteer for the surrender of their carts.

Carts have many safety features installed to ensure users have access to a safe shelter. In a case where you feel unsafe, simply take your makePretty to the nearest distribution center and a volunteer will do their best to ensure your cart is updated with safety features that help you.

Plants on the makePretty cart are in fact live plants, and as such do attract pollinators and other insects to fulfill their ideal biological life cycle. makePretty plants were specifically chosen to match the aesthetics of the city. To ensure optimal plant coverage please see the section about [plants](#).

In the event that the makePretty cart doesn't work for you, you can voluntarily surrender the cart and kit at any distribution center, keep in mind that the disbursement for the care of the cart, will also be required to be paid back in installments, if you choose to surrender the cart. Please ensure that if you choose to return the cart, all plants are either maintained or discarded, and the inside of the cart is free from any personal property or sharp objects, we thank you in advance for your commitment to cleanliness and safety for our volunteers.

Reference Information & Safe Operation Practices:

Read this operator manual carefully in its entirety before attempting to assemble this cart(here after makePretty). Read, understand and follow all instructions on the cart and in the manual before operation. Please keep this manual in a safe place so you can refer to it.

HEED ITS WARNING!



WARNING! This symbol points out important safety instructions which, if not followed could endanger the personal safety and property of yourself and others. Read and Follow all instructions in this manual before attempting to operate this object.

General Operation:

- 1.Do not water makePretty plants with users inside the structure, doing so may result in premature death of occupants.
- 2.Regularly check inside spaces for insects or debris that is sharp or can cause bodily harm, spaces inside of the makePretty should be clean from debris.
- 3.Watch out for insects that use the makePretty as a home, when using the makePretty kit, be mindful that the insects are useful for biodiversity and are an essential part of the makePretty experience.
- 4.Use the makePretty in a responsible manner, walk never run with the makePretty in its pushcart configuration.
- 5.Only use parts and accessories made for this machine by the manufacturer. Failure to do so can result in personal injury.
6. If hooked up in bike trailer configuration, be mindful of your size and shape as you take turns and corners. Your makePretty cart will swing in a wide arc.

7. When organizing your root systems from inside the makePrettyt, please ensure that roots are free from mold or rot. If you spot root rot or mold please remove portions of that root and discard.

8. Wear sturdy shoes and close fitting clothes when using makepretty. Ideally care and reasonable judgement should be used when operating makePretty. Ensure you keep all hands and feet away from the rotating and shifting pieces of the makePretty cart. Failure to do so can result in sprains, bruises or cuts from pinch points.

9. If situations occur which are not covered in this manual use care and good judgement, Contact the nearest distribution center, for assistance or the name of the nearest mechanic to assist you.



WARNING! This Machine was built to be operated according to the safe operation practices in this manual. As with any type of locomotive equipment, carelessness or error on the part of the operator can result in serious injury, up to and including death.

Getting Started:

Please read this entire manual prior to operating the makePretty cart. It can instruct you how to safely and easily set up, operate and maintain your cart. Please be sure that you and any other persons who will use the makePretty cart carefully follow the recommended safety practices at all times. Failure to do so could result in personal injury or property damage, not liable by the city. Characteristics and features discussed and or illustrated in this manual may not be applicable to all models, We reserve the right to change product specifications, designs, and equipment without notice and without incurring obligation.

If applicable the testing information used to establish the plant zone rating equipped on this cart can be found at www.vancouverpretty.com or the manufacturers website.

Care & Use:



WARNING! The warranty on this cart does not cover items that have been subjected to operator abuse or negligence. To receive full value from warranty, the operator must maintain the cart as instructed.

Always observe safety rules when performing any maintenance.

Maintenance:

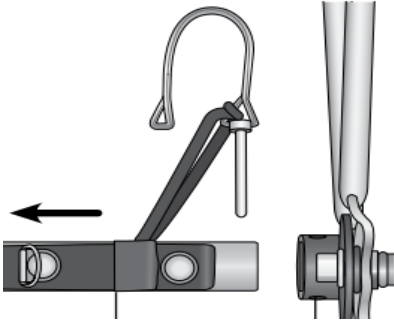

FIG.2-1

Periodically check all fasteners and make sure these are tight. If they are not tight please tighten them with the phillips screwdriver.

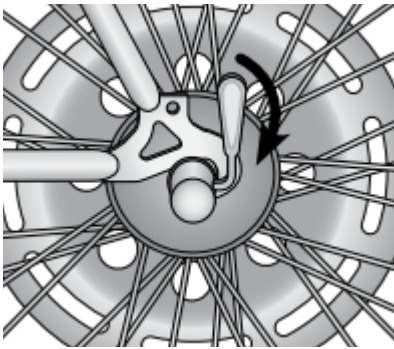

FIG. 2-2

Changing or modifications of wheels will adversely affect performance of the cart. Wheel modification may result in death.

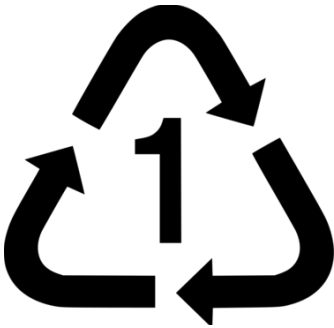
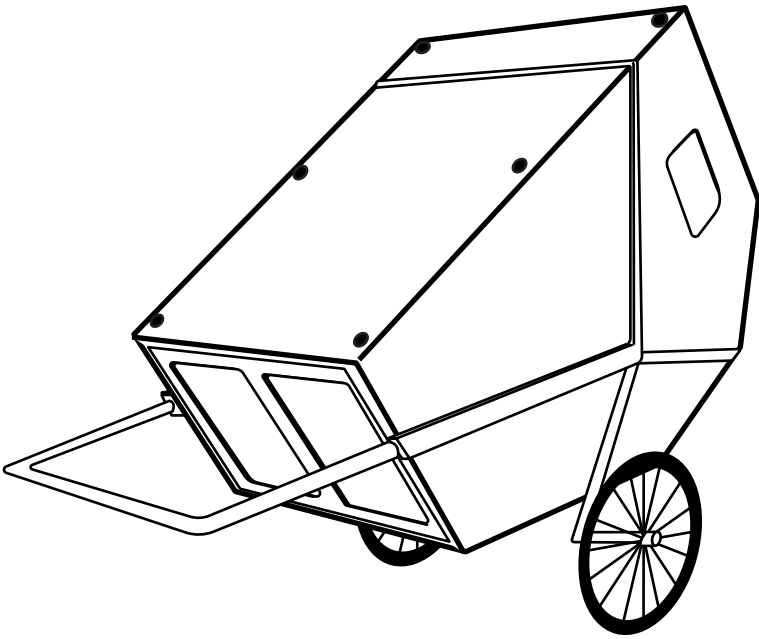

FIG. 2-3

All adjustments and hold-safes should be checked at least once each season. Failure to do so may result in objects falling of your makePretty cart.



Cart insides come pre furnished with one (1) integrated foam sleeping pad, further modifications for your comfort maybe necessary. When taking care of your makePretty cart, please ensure that you do not light, smoke or release anything flammable within the cart, as this could lead to an unsafe fire situation.

The inside foam padding of the cart has a height of 10mm and has a compression rating of 300 PSI, as such it is recommended participants in the makePretty programme do not modify or try to extend the foam padding in the cart without supervision from a designated makePretty volunteer.

Your cart's "deck" may be equipped with side vents to help facilitate the drainage of water accumulated in your cart, Use the deck to rinse debris from the deck's top side if needed, the foam mat included within the design is waterproof and prevents the build up of grime.



DO NOT use corrosives to clean the inside of your cart.

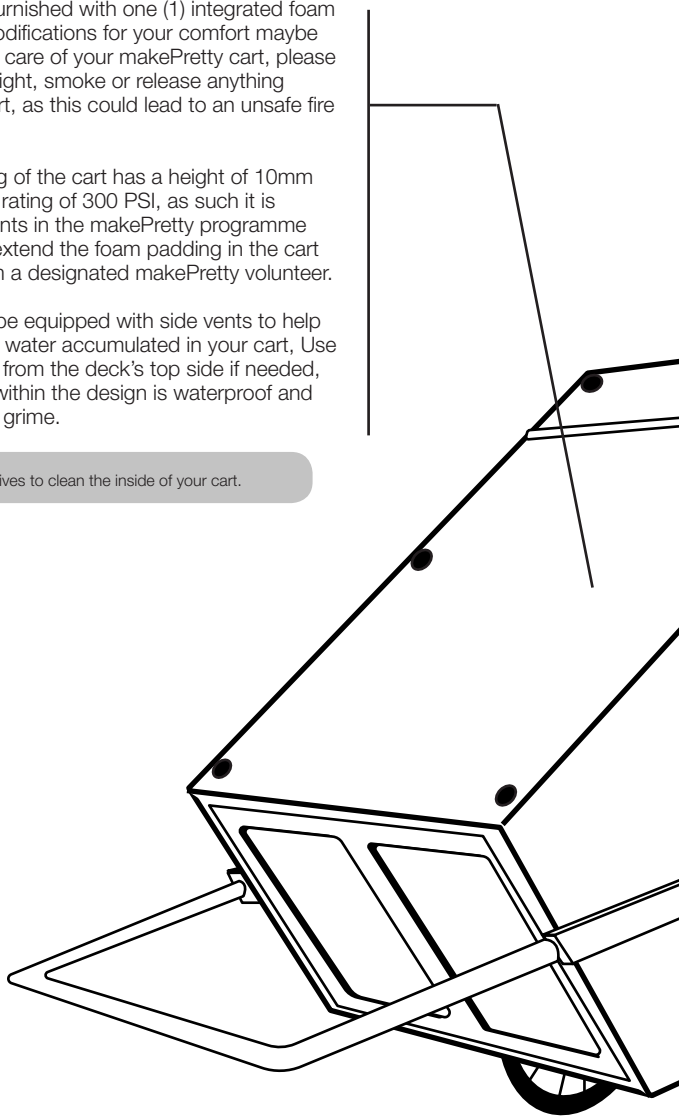

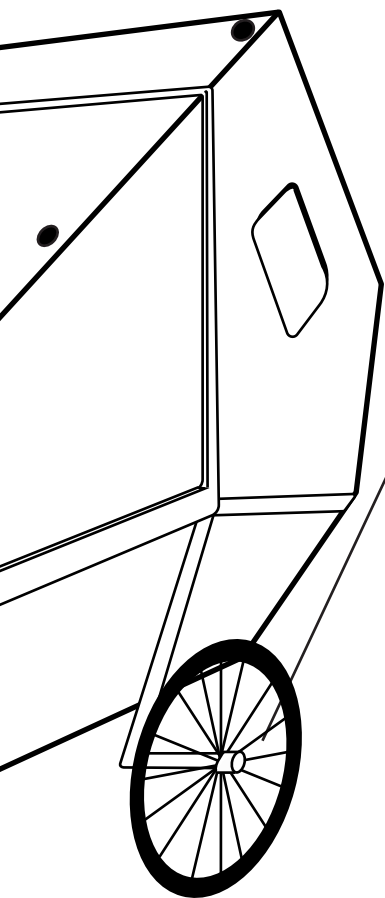

Cart wheels are designed to be removable for easier transportation and for repair of a tire puncture. In most cases, the wheel axles are inserted into slots in the frame. Your cart may be equipped with a different securing method for the dual axis of the wheels, if it is a cause of concern you should discuss the wheel securing method with a makePretty volunteer.

In current makePretty carts we ensure that the wheels are true in alignment with each other, failure to do so may result in catastrophic failure of the cart, and you may wind up injuring a person.

Please ensure tires are properly inflated before disembarking from the service and distribution centers, if needed ask an attendant for help to align your tire



DO NOT modify the wheels in anyway.

Plant Index

Japanese Aucuba 'Golden Sparks'



Watering

Average 2-3 times a week

Zone System

7b through 10a

Information

Japanese aucuba (*Aucuba japonica*) is an evergreen shrub that grows 6 to 10 feet (2-3 m.) tall with colorful, green and yellow-gold leaves as much as 8 inches (20 cm.) long. The flowers aren't particularly ornamental, but attractive, bright red berries replace them in the fall if a male plant grows nearby. The flowers and fruit often hide behind the foliage. Aucuba also makes nice container shrubs or houseplants.

Caretakers Notes:

Aucuba shrubs have moderate drought tolerance, but they grow best in moist soil. Water often enough to keep the soil moderately moist using cold water. Hot water from a hose that has been left in the sun can encourage disease. Spread a 2- or 3-inch (5-7.5 cm.) layer of mulch over the roots to help the soil hold moisture and prevent weeds.

Mahonia Aquifolium



Watering

1-2 times a week

Zone System

4 through 9

Information

All three are evergreen and have the characteristic holly-like leaf shape, some more pointed and prickly than others. Woody-stemmed and spreading by rhizomes, the new growth in the spring emerges in a light green to soft coppery-red color; at the other end of the year the foliage responds to colder weather by taking on shades of bright red to burgundy - truly lovely in the grayed winter landscape.

In early-spring, the plant is topped with sprays of small bright yellow fragrant flowers in a long-blooming display that attract bees, hummingbirds and other pollinators to the garden. Following the bloom are clusters of dusky blue, round to oblong berries that are the “grapes” that give it its common name.

Caretakers Notes:

Grows best in partial sun - though some species can thrive in full shade to full sun - rich acidic soil, and to moist to dry conditions. Avoid planting Oregon grape in soil that is compacted, wet, or too alkaline; plants should also be protected from winter winds

Calluna Vulgaris : ‘Firefly’



Watering

Average 2-3 times a week

Zone System

6a through to 8a

Information

Evergreen, Heathers (*Calluna Vulgaris*) and Heaths (*Erica*) are terrific plants that deserve a spot in the cart. Their fabulous ability to change color year-round, injecting vivid life into our landscape at a time when they need it most, is invaluable. Low maintenance, deer or salt resistant, winter hardy, drought tolerant (once established) and fairly easy to grow, they do not require much: decent drainage and some sunshine.

Caretakers Notes:

Firefly Heather will grow to be about 12 inches tall at maturity, with a spread of 24 inches. It tends to fill out right to the ground and therefore doesn't necessarily require facer plants in front. It grows at a slow rate, and under ideal conditions can be expected to live for approximately 20 years.

This shrub should only be grown in full sunlight. It requires an evenly moist well-drained soil for optimal growth, but will die in standing water. It is very fussy about its soil conditions and must have sandy, acidic soils to ensure success, and is subject to chlorosis (yellowing) of the leaves in alkaline soils.

Jasminum Nudiflorum



Watering

4 times a week at minimum

Zone System

6a through to 9a

Information

Winter jasmine plants are deciduous perennials. They are considered vines or viney shrubs and belong to the olive family. Unlike most jasmines, this type is not fragrant, but, perhaps as a tradeoff, the plant's stems stay green in winter. Winter jasmine plants are native to China.

Caretakers Notes:

If you are going to prune these plants just once over the course of the year, the ideal time to do so is in spring, right after they have bloomed. They flower on old wood, so by pruning at this time, you will not lose any flowers for next year. If you want to control their spreading, you may want to prune multiple times, even though it means fewer flowers for next spring.

The plants do not need to be fertilized very much, but if you want them to get especially big for any reason, work some compost into the ground around them.

